

Oem for customers, used at different applications

- **136**
Micro Solenoid Valve
- **137-139**
Low Pressure Solenoid Valve
- **139-140**
High Pressure Solenoid Valve
- **141**
Normal Open Solenoid Valve
- **141-143**
Valve for truck application
- **144-150**
Special Solenoid Valve
- **151-157**
Valve Group
- **156-157**
Freon Valve
- **158-159**
Dry type Lever Valve

XY-10 Micro valves

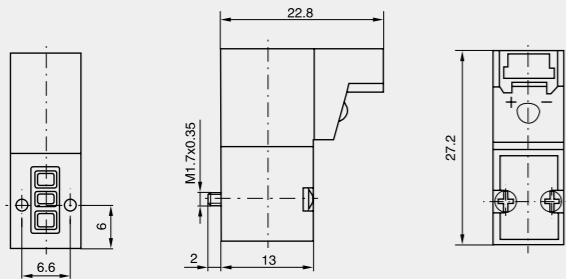

Features

1. Single or manifold for different applications, one inlet with some outlets based on manifold
2. Mostly used as pilot valves for the pilot type valves or control the mini cylinders
3. Very low power, is suitable for PC control system
4. Compact design, light and easy for assembly
5. No lubrication requested, long life design
6. Led indicator and protection circuit with coil

Technic data

Model	XY-10
Media	Compressed air
Working type	Direct action 2/2 3/2
Pattern	Normally close
Orifice	0.7mm
Connection ports	M3~M5 Manifold
Working pressure	0-0.7MPa
Working temp.	-5°C ~ -55°C
Rated voltage	DC12V/DC24V ±10%
Power	1.3W
Protection class	IP65
Insulation class	F class
Valve body material	POM, PPS
Seal material	NBR

51001 Low pressure valves

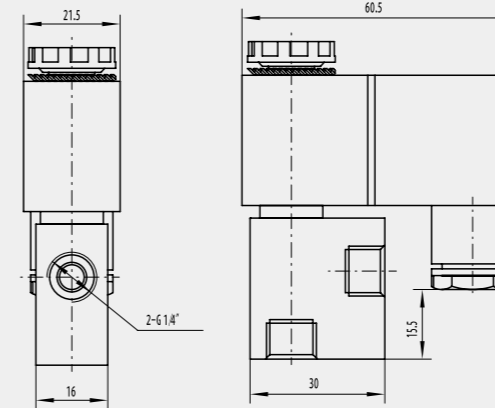

Features

- Compact design with right angle inlet and outlet ports
- Low pressure for gas burner application
- Small power consumption

Technic data

Model	51001
Media	Clean Air / Gas
Working type	Direct action 3/2
Pattern	Normally close
Orifice	1mm/5mm
Connection ports	G1/8" G1/4"
Working pressure	0-0.8MPa/0-150mbar
Max. pressure	1.2MPa
Working temp.	-10°C ~ 80°C
Rated voltage	AC24V-220V ±10%
Power	6VA
Protection class	IP65
Insulation class	F class
Valve body material	Aluminum
Seal material	NBR / FKM

XY-15 Micro valves

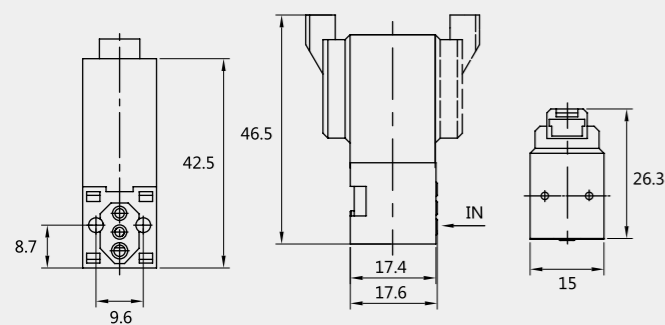

Features

1. Single or manifold for different applications, one inlet with some outlets based on manifold
2. Mostly used as pilot valves for the pilot type valves or control the mini cylinders
3. Very low power, is suitable for PC control system
4. Compact design, light and easy for assembly
5. No lubrication requested, long life design
6. Led indicator and protection circuit with coil

Technic data

Model	XY-15
Media	Compressed air
Working type	Direct action 2/2 3/2
Pattern	Normally close (Direct action)
Orifice	1.6mm
Connection ports	M3~M5 Manifold
Working pressure	0-0.7MPa
Working temp.	-5°C ~ -55°C
Rated voltage	DC12V/DC24V ±10%
Power	2.3W
Protection class	IP65
Insulation class	F class
Valve body material	POM, PPS
Seal material	NBR

52001/52001-1 pressure valves

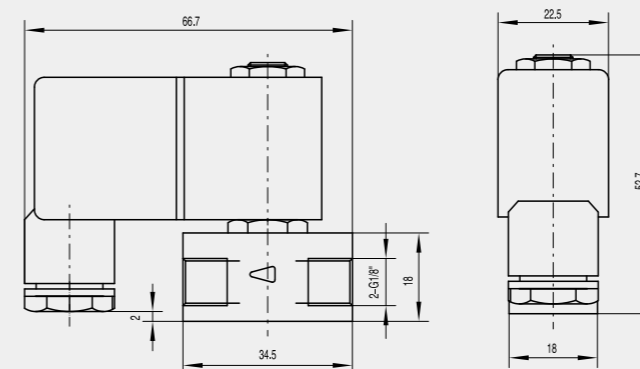

Features

- Compact design with in line inlet and outlet ports
- Low pressure for gas burner application
- Small power consumption

Technic data

Model	52001	52001-1
Media	Clean Air / Gas	
Working type	Direct action 2/2	
Pattern	Normally close	
Orifice	3.1mm	4.0mm
Connection ports	G1/8"	
Working pressure	0-150mbar	
Max. pressure	1.0MPa	
Working temp.	-10°C ~ 80°C	
Rated voltage	AC24V-220V ±10%	
Power	6VA	
Protection class	IP65	
Insulation class	F class	
Valve body material	Aluminum	
Seal material	NBR / FKM	

TEX891 Gas burner valve

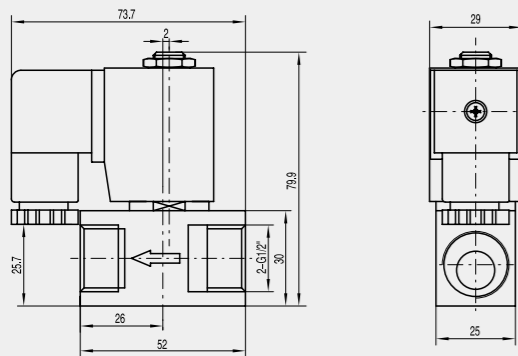

Features

Big orifice for low pressure fluid, like low pressure gas.
Rusty resistant based on anodized surface.

Technic data

Model	TEX891
Media	Clean Air / Gas
Working type	Direct action 2/2
Pattern	Normally close
Orifice	10mm
Connection ports	G1/2"
Working pressure	400mbar
Max. pressure	1.0MPa
Working temp.	-10°C ~ 80°C
Rated voltage	AC/DC24V-220V ±10%
Power	AC22VA/DC14W
Protection class	IP65
Insulation class	F class
Valve body material	Aluminum
Seal material	NBR / FKM

LTSA016 Latch valve

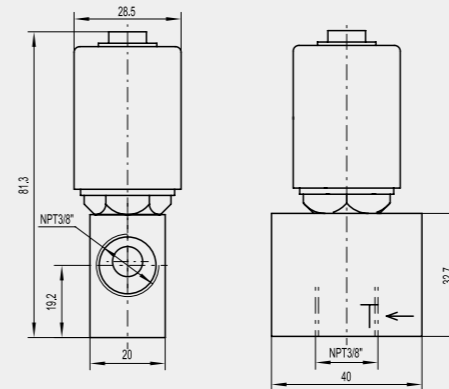

Features

Latch valve used for gas burner, low power consumption.

Technic data

Model	LTSA016
Media	Compressed air / Gas
Working type	Direct action Bistable type
Pattern	Normally close
Orifice	7mm
Connection ports	NPT3/8"
Working pressure	150mbar
Rated voltage	DC6-9V
Power	10W

RGT-15 Gas valve

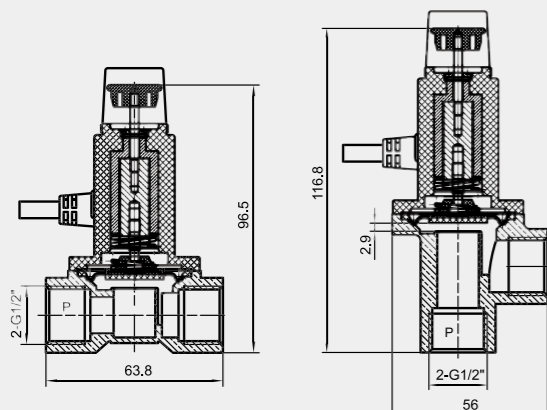

Features

1. Safety valve used in gas pipe line.
2. Normally open type, shut off immediately when gas detector give signal.
3. Diaphragm type with big office.
4. Bistable type with low power consumption.

Technic data

Model	RGT-15	RGZ-15
Media	Gas / Compressed air	
Working type	Pilot type diaphragm valve	
Pattern	Direct action 2/2	
Orifice	16mm	
Connection ports	G1/2"	
Working pressure	250mbar	
Max. pressure	8bar	
Working temp.	-20°C ~ 180°C	
Rated voltage	DC6V-24V ±10%	
Power	5W	
Protection class	IP65	
Insulation class	F class	
Valve body material	Brass	
Seal material	NBR / FKM	

HP250/350 High pressure valve

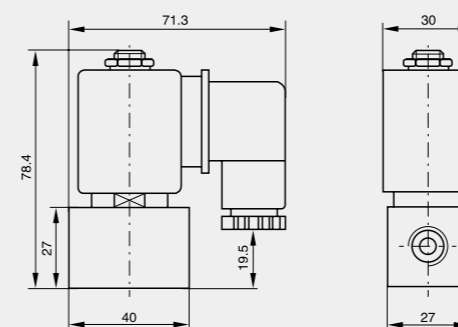

Features

For special very high pressure applications
SUS316 material with good Acid and alkali resistant

Technic data

Model	HP250	HP350
Media	Clean Air / Water	
Working type	Direct action 2/2	
Pattern	Normally close	
Orifice	1mm	
Connection ports	G1/8" -G1/2"	
Working pressure	0-20MPa	0-35MPa
Max. pressure	45MPa	
Working temp.	-10°C ~ 120°C	
Rated voltage	AC/DC24V-220V ±10%	
Power	AC22VA/DC14W	
Protection class	IP65	
Insulation class	F class	
Valve body material	Stainless steel SUS316	
Seal material	PTFE	

KS-40 High pressure NO valve

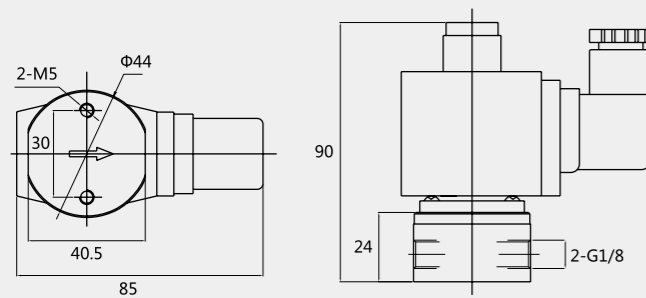

Features

Normally open valve for high pressure application
0-4MPa

Technic data

Model	KS-40
Media	Clean Air / Water
Working type	Direct action 2/2
Pattern	Normally open
Orifice	1.5mm
Connection ports	G1/8"
Working pressure	0-4.0MPa
Max. pressure	6.0MPa
Working temp.	-20°C ~ 120°C
Rated voltage	RAC220/RAC380 ±10%
Power	10W
Protection class	IP65
Insulation class	F class
Valve body material	Brass
Seal material	VITON

RV03162K Normally open valve

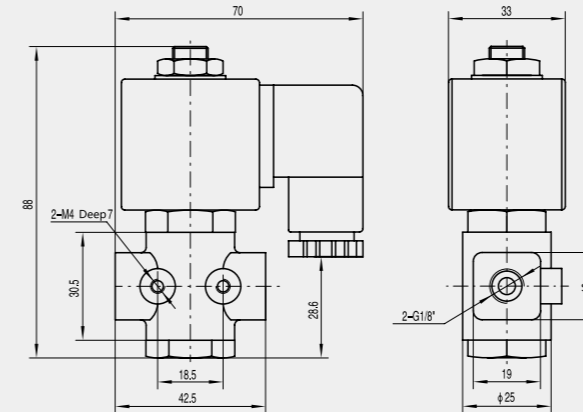

Features

Normally open with bottom valve seat, perfect and stable function

Technic data

Model	RV03162K
Media	Clean Air
Working type	Direct action 2/2
Pattern	Normally open
Orifice	2mm
Connection ports	G1/8"~G1/4"
Working pressure	0-1.0MPa
Max. pressure	2MPa
Working temp.	-10°C ~ 80°C
Rated voltage	AC/DC24V-220V ±10%
Power	AC18VA/DC19W
Protection class	IP65
Insulation class	H class
Valve body material	Brass
Seal material	VITON

RSS210-70 High pressure NC valve

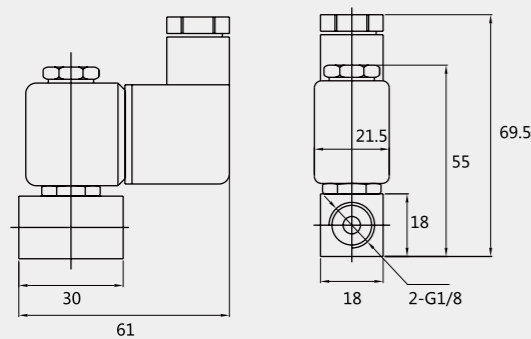

Features

Compact valve for high pressure application, good Acid and alkali resistant, low power consumption

Technic data

Model	RSS210-70
Media	Compressed air/ Water
Working type	Direct action 2/2
Pattern	Normally close
Orifice	1.0mm
Connection ports	G1/8"
Working pressure	0-7.0MPa
Max. pressure	10MPa
Working temp.	-20°C ~ 120°C
Rated voltage	DC12V-24V/AC24V-220V ±10%
Power	AC6VA/DC6W
Protection class	IP65
Insulation class	F class
Valve body material	Stainless steel SUS316
Seal material	VITON

ESD Valve for truck application

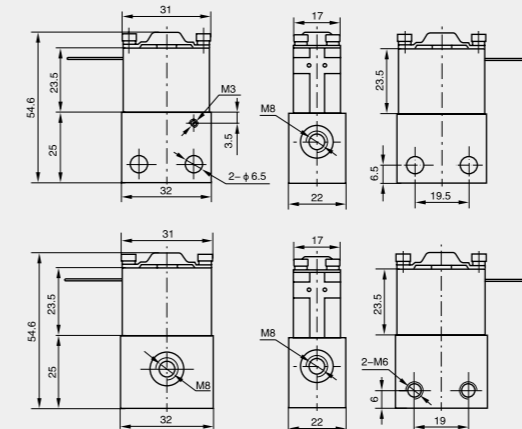

Features

Used for automobile flameout system.
With good dust-proof and shake-proof design

Technic data

Model	ESD21/ ESD22
Media	Compressed air
Working type	Direct action 3/2
Pattern	Normally close
Orifice	0.6mm
Connection ports	M8×1/M8×1.25
Working pressure	0-0.8MPa
Max. pressure	1.6MPa
Working temp.	-40°C ~ 100°C
Rated voltage	DC12V/DC24V/DC48V ±10%
Power	3.2W
Protection class	IP65
Insulation class	F class
Valve body material	Aluminum
Seal material	FKM, NBR

QCFG Valve for truck application

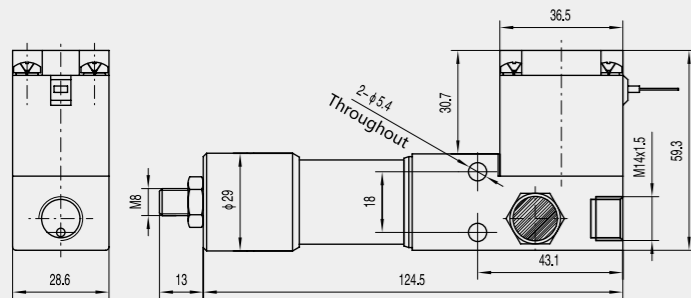

Features

Used for automobile flameout system.
With good dust-proof and shake-proof design

Technic data

Model	QCFG
Media	Compressed air
Working type	Direct action 2/2
Pattern	Normally close
Orifice	0.9mm
Connection ports	M14×1.5
Working pressure	0-0.8MPa
Max. pressure	1.6MPa
Working temp.	-40°C ~ 120°C
Rated voltage	DC12V/DC24V ±10%
Power	4.5W
Protection class	IP65
Insulation class	F class
Valve body material	Aluminum
Seal material	FKM

88600 Valve for truck application

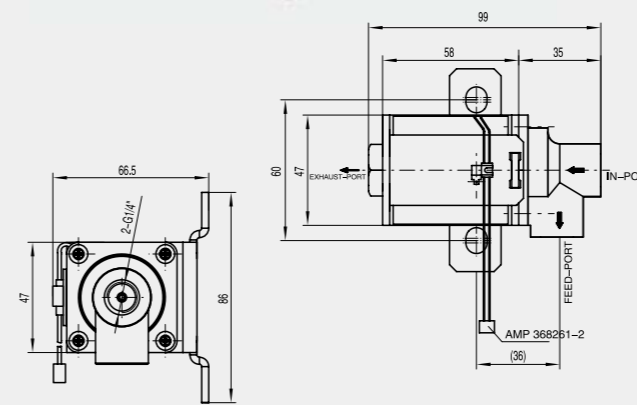

Features

Used for pneumatic control system in truck, with
good dust-proof and shake-proof design

Technic data

Model	88600
Media	Compressed air
Working type	Direct action 3/2
Pattern	Normally close
Orifice	1.9mm
Connection ports	G1/4"
Working pressure	0-1.0MPa
Max. pressure	1.6MPa
Working temp.	-40°C ~ 80°C
Rated voltage	DC12V/24V ±10%
Power	12W
Protection class	IP65
Insulation class	F class
Valve body material	Zinc alloy
Seal material	NBR

WP-1 Valve for truck application

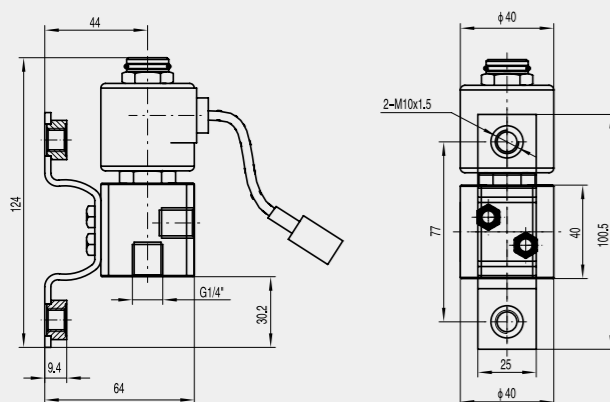

Features

Used for pneumatic control system in truck, with
good dust-proof and shake-proof design

Technic data

Model	WP-1
Media	Compressed air
Working type	Direct action 2/2 2/3
Pattern	Normally close
Orifice	1.5mm
Connection ports	M10×1.5 - G1/4"
Working pressure	0.3~0.9MPa
Max. pressure	1.6MPa
Working temp.	-10°C ~ 80°C
Rated voltage	AC/DC24V-220V ±10%
Power	12W
Protection class	IP65
Insulation class	F class
Valve body material	Aluminum
Seal material	NBR, FKM

WP03103 Valve for truck application

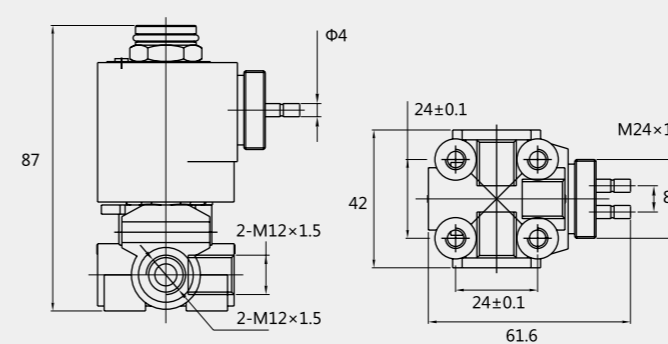

Features

Valve for automobile application.
Nice dust-proof design with O-ring on cap.

Technic data

Model	MP-3L
Media	Compressed air
Working type	Direct action 3/2
Pattern	Normally close
Orifice	Φ3mm
Connection ports	M12×1.5
Working pressure	4.5~10bar
Working temp.	-10°C ~ 55°C
Rated voltage	DC24V ±10%
Power	12W
Protection class	IP65
Insulation class	F class
Valve body material	Zinc alloy
Seal material	VITON

F17 Valve for gasoline

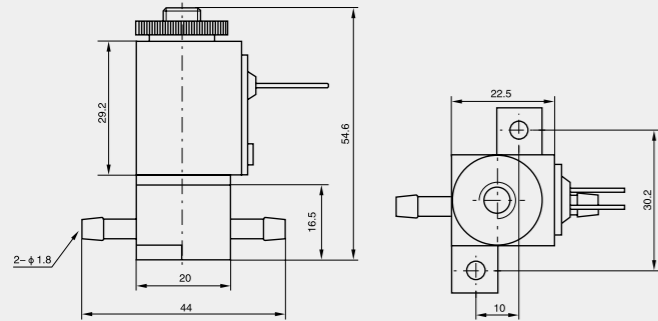

Features

Body made from POM, seal made from solvent resistant material, valve is good for solvent like gasoline and so on.
Compact design with cable connection ports, easy for assembly.

Technic data

Model	F17
Media	Petrol/Solvent
Working type	Direct action 2/2
Pattern	Normally close
Orifice	1.8mm/3mm
Connection ports	Φ4mm cable/Φ6mm cable
Working pressure	0-0.35MPa
Max. pressure	0.8MPa
Working temp.	-40°C ~ 80°C
Rated voltage	AC/DC24V-220V ±10%
Power	4.5W
Protection class	IP65
Insulation class	F class
Valve body material	POM
Seal material	FKM

AASMA Valve for diesel oil charging machine

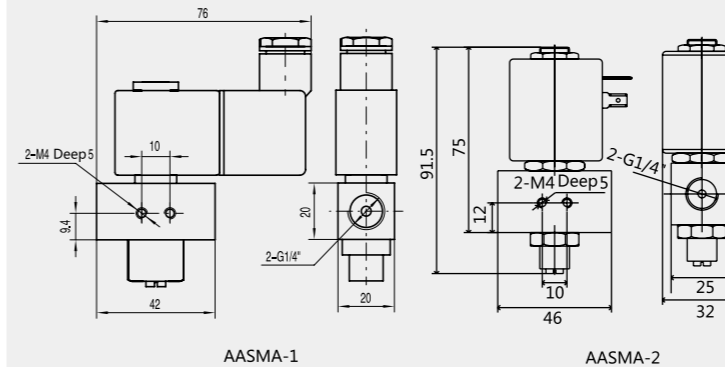

Features

1. Double flow pathways
2. Flow rate adjustable
3. Can be for other media when other seals used

Technic data

Model	AASMA-1/AASMA-2
Media	Diesel / Clean Air / Water
Working type	Direct action 2/2
Pattern	Normally close
Orifice	3mm
Connection ports	G1/4" / M5 / G1/8"
Working pressure	0-1.0MPa
Max. pressure	1.6MPa
Working temp.	-10°C ~ 80°C
Rated voltage	DC12V/DC24V ±10%
Power	12W
Protection class	IP65
Insulation class	H class
Valve body material	Brass
Seal material	NBR / FKM

POU Valve for beverage machines

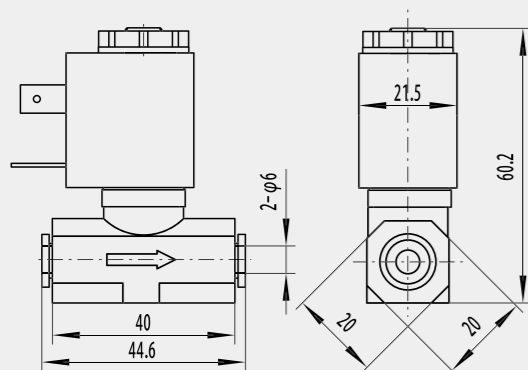

Features

1. Special on/off control valve for beverage machine
2. High quality food grade material, comply with ROHS indicate
3. Push fitting type connection, easy for assembly

Technic data

Model	POU
Media	Clean Air / Water / Beverage
Working type	Direct action 2/2
Pattern	Normally close
Orifice	2.5mm
Connection ports	6mm cable
Working pressure	0-0.6MPa
Max. pressure	1.2MPa
Working temp.	-10°C ~ 130°C
Rated voltage	AC24V-220V ±10%
Power	7VA
Protection class	IP65
Insulation class	F class
Valve body material	SUS316
Seal material	Silicon

SB156/157 valve for printing machine

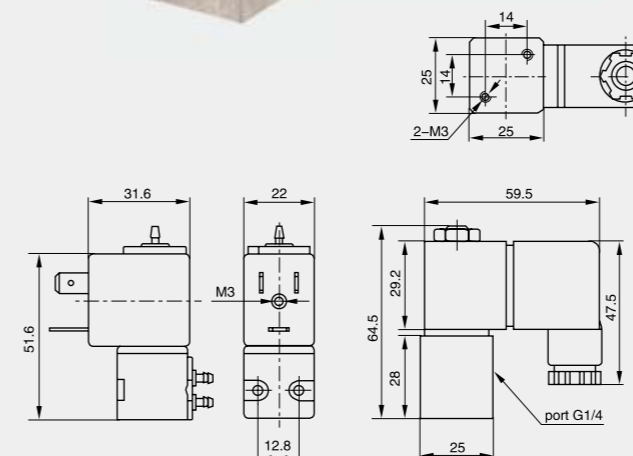

Features

Made from solvent resistant material, valve is good for solvent like ink and so on.
Compact design with cable connection ports, easy for assembly.
3way and 2way are optional.

Technic data

Model	SB156	SB157
Media	Ink / Solvent	
Working type	Direct action 2/2 3/2	
Pattern	2/2:Normally close 3/2:NC / NO / Divert	
Orifice	2mm	3mm
Connection ports	M5, G1/8"	2.5mm cable
Working pressure	0-0.6bar	
Max. pressure	16bar	
Working temp.	-10°C ~ 100°C	
Rated voltage	DC24V ±10%	
Power	7W	
Protection class	IP65	
Insulation class	F class	
Valve body material	Stainless steel SUS316	POM
Seal material	EPDM	

ELS/ELS-B/ELS-3B Pilot valve

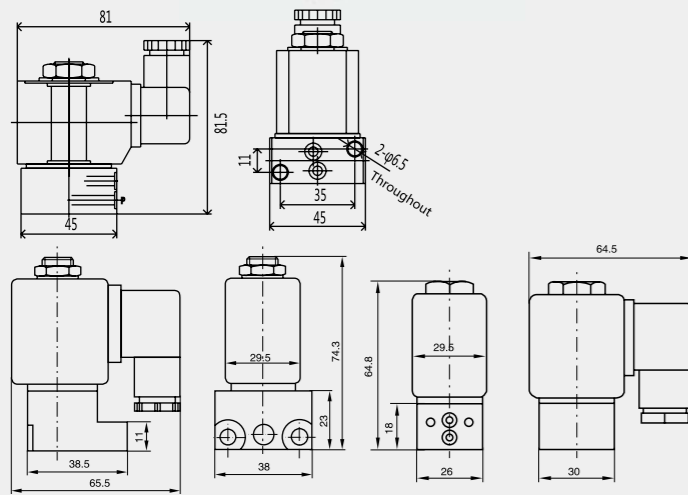

Features

Nice design with small flow resistance.
Moving core made from high quality material without residual magnetism.

Technic data

Model	ELS/ELS-B	ELS-3B
Media	Clean Air	
Working type	Direct action 2/2	
Pattern	Normally close	
Orifice	Φ 1.3mm	Φ 2.5mm
Working pressure	0-0.8MPa	0-1.0MPa
Working temp.	-10°C ~ 40°C	
Rated voltage	AC/DC24V-220V ±10%	
Power	AC9VA-15VA/DC7W-12W	
Protection class	IP65	
Insulation class	F class	
Valve body material	Aluminum	
Seal material	VITON	

V165B06/V185B06 Ozone valve

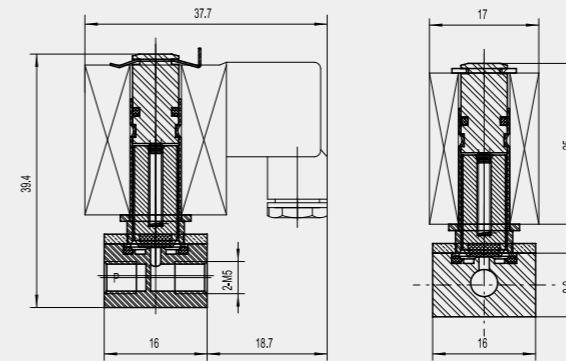

Features

Compact valve for mini automatic machine.

Technic data

Model	V165B06	V185B06
Media	Compressed air / Ozone	
Working type	Direct action 2/2	Direct action 3/2
Pattern	Normally close	
Orifice	1.6mm	1.8mm
Connection ports	M5	
Working pressure	0~1.0MPa	-0.1~0.1MPa
Max. pressure	2.0MPa	
Working temp.	-10°C ~ 80°C	
Rated voltage	AC/DC24V-220V ±10%	
Power	AC4VA/DC2.8W	
Protection class	IP65	
Insulation class	F class	
Valve body material	Brass / Stainless steel SUS316	
Seal material	EPDM	

SB114 Valve for dental machine

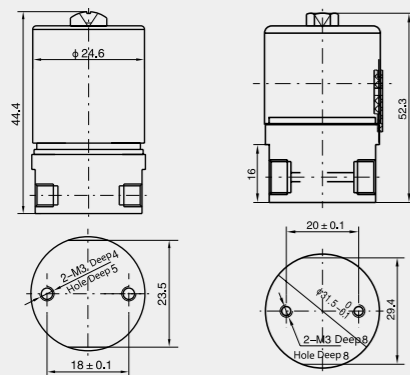

Features

- Used for dental machine, control the on/off the clean water or air.
- Compact construction.
- Metal house which is rusty resistant.

Technic data

Model	SB114
Media	Clean Air / Water
Working type	Direct action
Pattern	Normally close
Orifice	1.2mm
Connection ports	M5 or bable
Working pressure	0~0.8MPa
Max. pressure	1.6MPa
Working temp.	-10°C ~ 80°C
Rated voltage	AC/DC24V-220V ±10%
Power	AC3.5VA/DC2.5W
Protection class	IP65
Insulation class	F class
Seal material	NBR

SB172 Latch valve

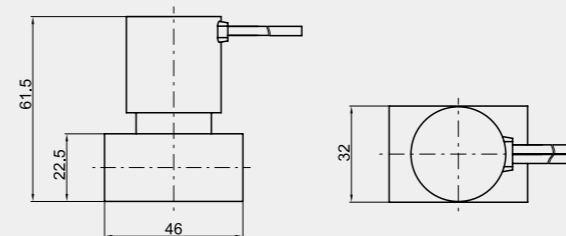

Features

Bistable design for power saving.
Brass body and aluminum body are optional.

Technic data

Model	SB172
Media	Clean Air / Water
Working type	Bistable
Pattern	Normally close
Orifice	2.0mm/2.5mm/6mm
Connection ports	G1/4" G1/2"
Working pressure	12bar/4bar/0.5bar
Max. pressure	2.0MPa
Working temp.	-10°C ~ 80°C
Rated voltage	DC12V/DC24V Pulse
Power	4.8~20W
Protection class	IP65
Insulation class	F class
Valve body material	Brass / Aluminum
Seal material	NBR, FKM

PJF Valve for beer machine

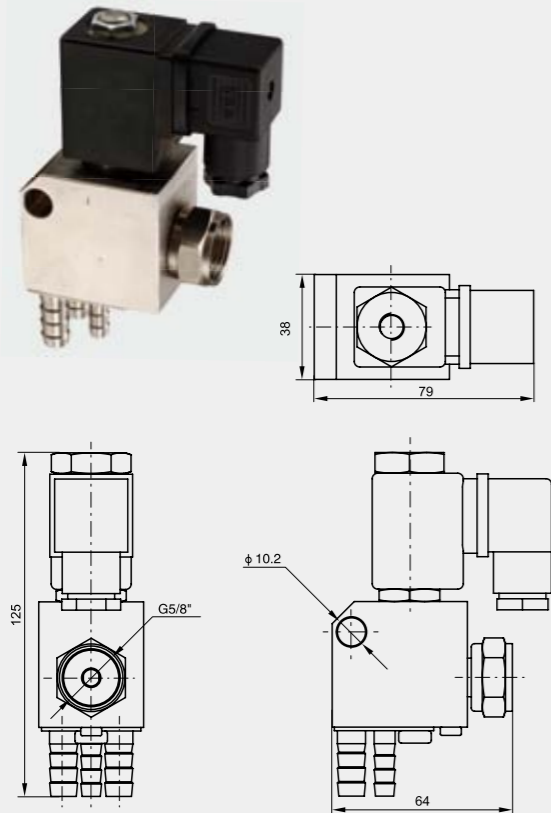

Features

1. Valve for food machine.
2. Comply with ROHS, food grade.
3. With special pathway for cooling fluid.

Technic data

Model	PJF
Media	Beer / Beverage
Working type	Direct action 2/2
Pattern	Normally close
Orifice	Φ6
Connection ports	G5/8"
Working pressure	500mbar
Max. pressure	3bar
Working temp.	0°C ~ 120°C
Rated voltage	AC/DC24V-240V ±10%
Power	AC28VA/DC20W
Protection class	IP65
Insulation class	H class
Valve body material	SUS316
Seal material	Silicon

SB167 Diaphragm valves

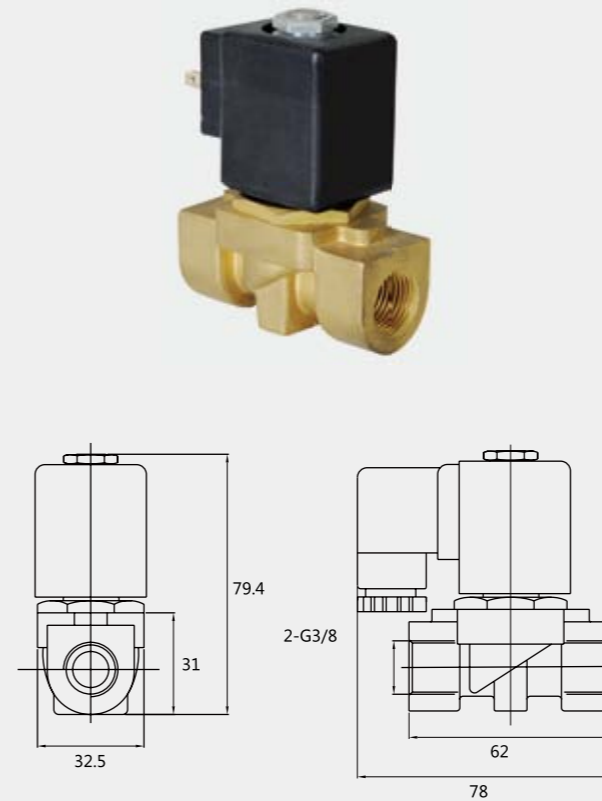

Features

1. Direct action type
2. Thermosetting coil, UL approved
3. Diaphragm type with big orifice
4. Suitable for different fluid based on different seals

Technic data

Model	SB167
Media	Compressed air
Working type	Direct action 2/2
Pattern	Normally close
Orifice	10mm
Connection ports	G1/4" G1/2"
Working pressure	0.1-1.6MPa
Max. pressure	2.5MPa
Working temp.	-20°C ~ 80°C
Rated voltage	AC/DC24V-220V ±10%
Power	AC12VA/DC15W
Protection class	IP65
Insulation class	F class
Valve body material	Brass
Seal material	NBR

RMF23-SS/RMF22-SS Multi-use stainless steel valves



Features

1. Widely used in different applications.
2. Different seals, different inlets, different pressure ranges are optional.
3. Include 3way and 2way types.

Technic data

Model	RMF23-SS	RMF22-SS
Media	Clean Air/ Water/ Oil /Solvent/Weak acid/Weak alkali	
Working type	Direct action 3/2	Direct action 2/2
Pattern	Normally close / Normally open	
Orifice (mm)	2	2 3 3.5 4 5
Working pressure (MPa)	NC 0.7	NO 0.7
	Divert 1.6	5.5 2.5 1.6 1.4 0.8
Connection ports	G1/8" G1/4" G3/8"	
Media temp.	0°C ~ 80°C / -40°C ~ 180°C	
Rated voltage	DC12~220V/AC24~380V/50/60Hz ± 10%	
Power	AC18VA/DC19W	
Valve body material	Stainless steel SUS316	
Seal material	NBR, EPDM, VITON	

SB360 2/2 SB360 3/2 Solenoid valves

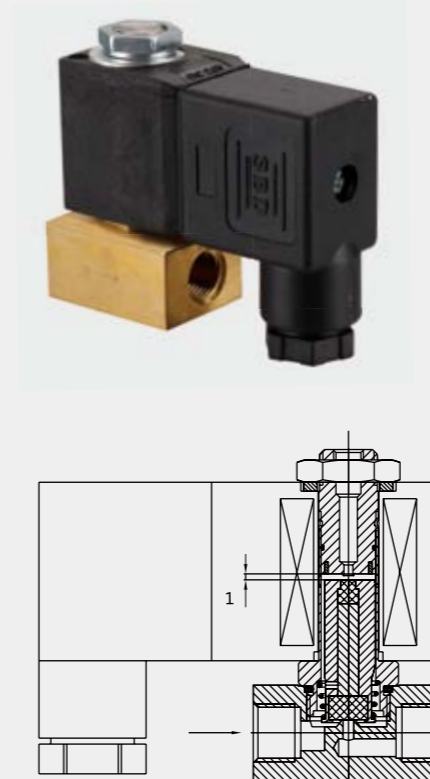

Features

Direct action valve, 3way or 2way for choice.

Technic data

Model	SB360 2/2	SB360 3/2
Media	Compressed air	
Working type	Direct action 2/2 3/2	
Pattern	Normally close / Normally open	
Orifice	2mm	1.8mm
Connection ports	G1/8"	G1/4"
Working pressure (MPa)	0~0.6	NC 0.3
		NO 0.7
		Divert 0.4
Working temp.	-40°C ~ 120°C	
Rated voltage	DC12V-DC24V ±10%	
Power	10W	
Protection class	IP65	
Insulation class	F class	
Valve body material	Brass	
Seal material	VITON	

VT312 Multi-use valve

Features

Multi-use three way valve with all three ports on valve body, easy for assembly

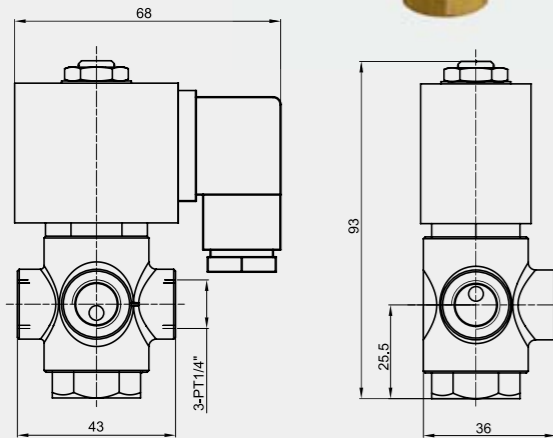

Technic data

Model	VT312
Media	Clean Air / Water / Oil
Working type	Direct action 3/2
Pattern	Normally close / Normally open
Orifice	2.0mm
Connection ports	G1/4"
Working pressure	0~10MPa
Valve body material	Brass
Seal material	VITON
Rated voltage	AC/DC24V-220V ±10%
Power	AC28VA/DC20W
Protection class	IP65

Function

inlet	1 Inlet (HX23)			2 Inlet (CB23)			3 Inlet (CK23)		
	2	1	3	3	1	2	3	1	2
Condition									
No power		→		↔			→		
Energized	←				←			↔	

R2 Pilot valve

Features

1. Can be used as single valve or assembled together as manifold.
2. 2way or 3way for choice.
3. L means qty. of the valves in one manifold, this qty. is depend on customers' application.

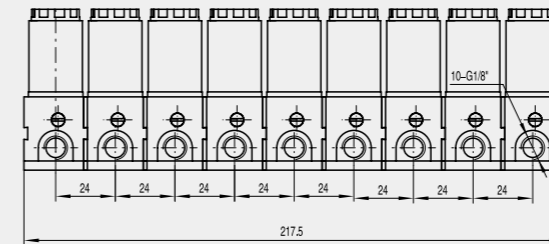
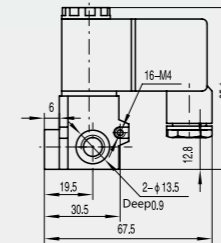

Technic data

Model	R2-8L
Media	Compressed air
Working type	Direct action 3/2
Pattern	Normally close
Orifice	1.2mm
Connection ports	G1/8"
Working pressure	0-0.8MPa
Max. pressure	1.6MPa
Working temp.	-10°C ~ 80°C
Rated voltage	AC/DC24V-220V ±10%
Power	AC5.5VA/DC4.8W
Protection class	IP65
Insulation class	F class
Valve body material	Zinc alloy
Seal material	NBR / FKM

RAL-01

Features

1. Can be used separately or as a pilot
2. Compact design
3. Made from aluminum or brass

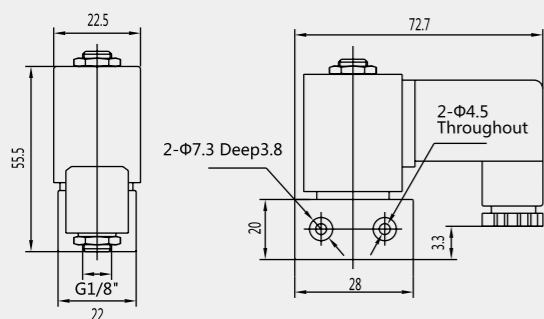

Technic data

Model	RAL-01
Media	Compressed air
Working type	Direct action 3/2
Pattern	Normally close
Orifice	1mm
Connection ports	G1/8"
Working pressure	2.0MPa
Working temp.	-10°C ~ 80°C
Rated voltage	AC/DC24V-220V ±10%
Power	AC5.5VA/DC4.8W
Protection class	IP65
Insulation class	F class
Valve body material	Aluminum
Seal material	NBR/FKM

LDXV valve

Features

Valve used for medical machine like lavage machine. L means qty. of the valves in one manifold, this qty. is depend on customers' application.

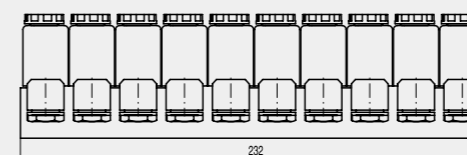
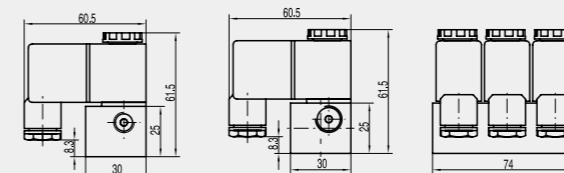

Technic data

Model	LDXV-3L/4L	LDXV-10L
Media	Clean Air	
Working type	Direct action 3/2	2/2
Pattern	Normally close	
Orifice	2.5mm	
Connection ports	G1/4"	G1/8"
Working pressure	-150mbar~150mbar	0~5bar
Max. pressure	1.6MPa	
Working temp.	-10°C ~ 80°C	
Rated voltage	AC/DC24V-220V ±10%	
Power	5.5VA×3(4)	5.5VA×10
Protection class	IP65	
Insulation class	F class	
Valve body material	Aluminum	
Seal material	NBR	

RKF-4L Valve for coffee machine

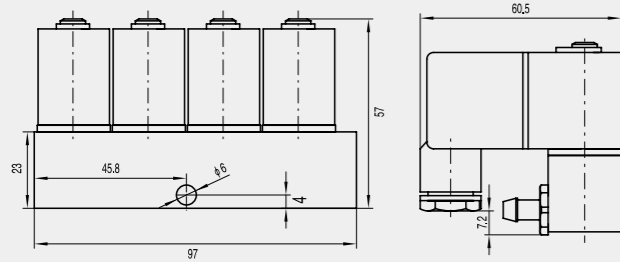

Features

Used for ON/OFF control of food fluid.
Food grade, comply with ROHS, withstand high temp.

Technic data

Model	RKF-4L
Media	Coffee / Beverage
Working type	Direct action 2/2
Pattern	Normally close
Orifice	2.5mm
Connection ports	6mm bable
Working pressure	0-1.0MPa
Max. pressure	3.5MPa
Working temp.	-10°C ~ 150°C
Rated voltage	DC12V/DC24V ±10%
Power	32W Total Power
Protection class	IP65
Insulation class	H class
Valve body material	SUS316 (Comply with ROHS)
Seal material	Silicon (Comply with ROHS)

SOVA42172 valve

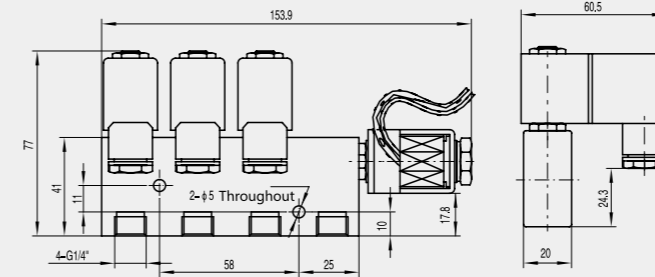

Features

Low pressure low voltage valve for gas application.

Technic data

Model	SOVA42172
Media	Clean Air / Gas
Working type	Direct action 2/2
Pattern	Normally close
Orifice	5mm
Connection ports	G1/4"
Working pressure	0-150mbar
Max. pressure	1MPa
Working temp.	-10°C ~ 80°C
Rated voltage	AC/DC24V-220V ±10%
Power	26.5W Total Power
Protection class	IP65
Insulation class	F class
Valve body material	Aluminum
Seal material	NBR

RFZ-10A Knitting machine

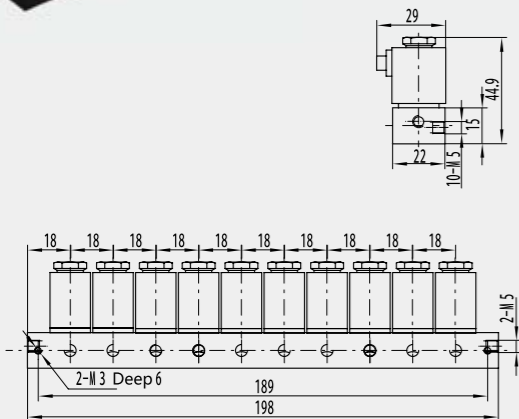

Features

Used for pneumatic control system of knitting machine.
Qty. of valve in one manifold can be changed according to application.

Technic data

Model	RFZ-10A
Media	Clean Air
Working type	Direct action 2/2 3/2
Pattern	Normally close
Orifice	0.7mm
Connection ports	M5
Working pressure	0-0.8MPa
Max. pressure	1.6MPa
Working temp.	-10°C ~ 80°C
Rated voltage	DC12V/DC24V ±10%
Power	2.8W×10
Protection class	IP65
Insulation class	F class
Valve body material	Aluminum (Anodized in black)
Seal material	NBR

RKT163-2L/RKT163-4L Big orifice valve

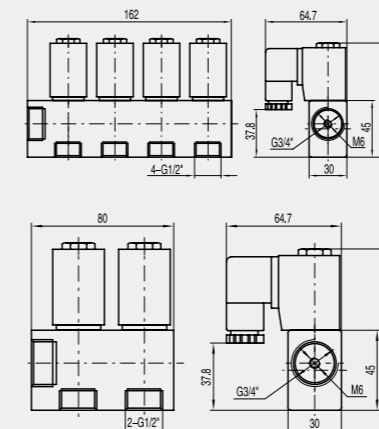

Features

Big orifice low pressure valve for gas burner or waste water treatment system.

Technic data

Model	RKT163-2L/RKT163-4L
Media	Clean Air / Gas
Working type	Direct action 2/2
Pattern	Normally close / Normally open
Orifice	12mm-13mm
Connection ports	G3/4" - G1/2"
Working pressure	0~350mbar
Max. pressure	1.0MPa
Working temp.	-10°C ~ 80°C
Rated voltage	AC/DC24V-220V ±10%
Power	AC22VA×2(4)/DC14W×2(4)
Protection class	IP65
Insulation class	F class
Valve body material	Aluminum
Seal material	NBR

RSB115 valve

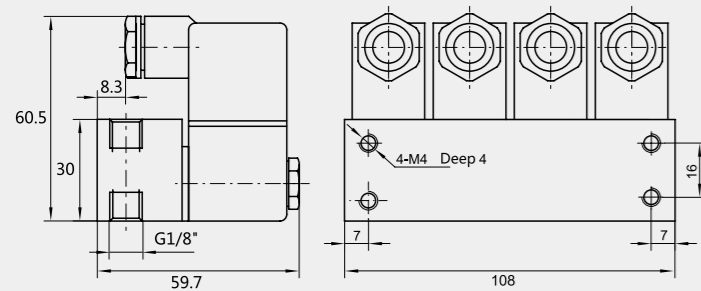

Features

Valve for water, air or oil

Technic data

Model	RSB115
Media	Clean Air / Water
Working type	Direct action 2/2
Pattern	Normally close
Orifice	2.5mm
Connection ports	G1/8"-G1/4"
Working pressure	0~0.8MPa
Max. pressure	2.5MPa
Working temp.	-10°C ~ 80°C
Rated voltage	AC/DC24V-220V ±10%
Power	AC6VA/DC6W
Protection class	IP65
Insulation class	F class
Valve body material	Brass
Seal material	NBR

SB162

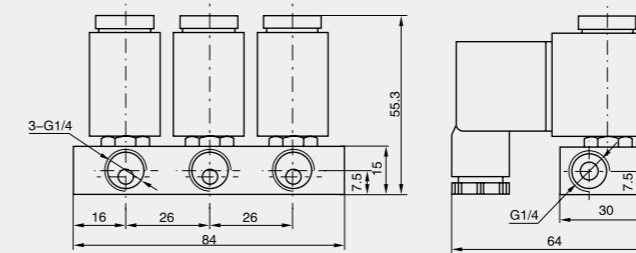

Features

Compact design, multi-use for water, air or oil.

Technic data

Model	SB162
Media	Compressed air/ Water / Oil
Working type	Direct action 2/2
Pattern	Normally close
Orifice	Φ2.5mm
Connection ports	G1/4"
Working pressure	0-0.8MPa
Working temp.	-10°C ~ 40°C
Rated voltage	AC/DC24V-220V ±10%
Total Power	AC18VA/DC18W
Protection class	IP65
Insulation class	F class
Valve body material	Brass
Seal material	NBR, FKM

SB163

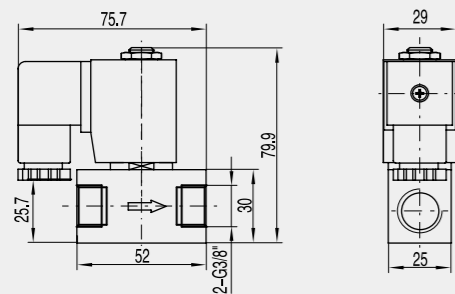

Features

Low pressure valve for gas burner or waste water treatment system.

Technic data

Model	SB163	SB163-4-A
Media	Clean Air	
Working type	Direct action 2/2	
Pattern	Normally close / Normally open	
Orifice	12mm/10mm/8mm	5mm
Connection ports	G1/2"	G1/4"
Working pressure	0-350mbar	0~2bar
Max. pressure	1.0MPa	
Working temp.	-10°C ~ 80°C	
Rated voltage	AC/DC24V-220V ±10%	
Power	AC22VA/DC14W	
Protection class	IP65	
Insulation class	F class	
Valve body material	Aluminum	
Seal material	NBR, FKM	

SBKV-2L/SBKV-6L

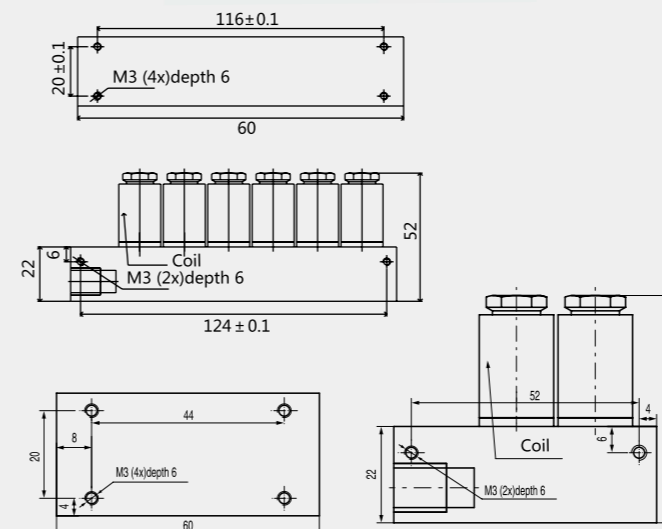

Features

Low pressure air valve, usually 2pcs manifold and 6pcs manifold for choice.

Technic data

Model	SBKV-2L/SBKV-6L
Media	Clean Air
Working type	Direct action 2/2
Pattern	Normally close
Orifice	2.6mm
Connection ports	G1/8"
Working pressure	0-500mbar
Max. pressure	1.6MPa
Working temp.	-10°C ~ 80°C
Rated voltage	AC/DC24V-220V ±10%
Power	3.5W×2/3.5W×6
Protection class	IP65
Insulation class	F class
Valve body material	Aluminum
Seal material	NBR / Silicon

MP-3L

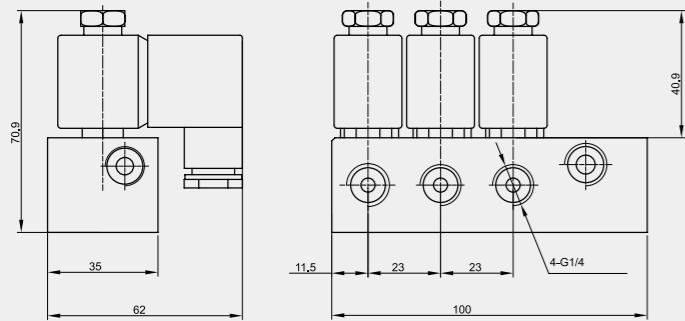

Features

Low pressure valve for waste water treatment system.

Technic data

Model	MP-3L
Media	Clean Air
Working type	Direct action 2/2
Pattern	Normally close
Orifice	Φ5mm
Connection ports	G1/4"
Working pressure	0-0.1MPa
Working temp.	-10°C ~ 80°C
Rated voltage	AC/DC24V-220V ±10%
Power	AC6VA×3/DC6W×3
Protection class	IP65
Insulation class	F class
Valve body material	Aluminum
Seal material	NBR

RV02352M-06B Latch freon valve

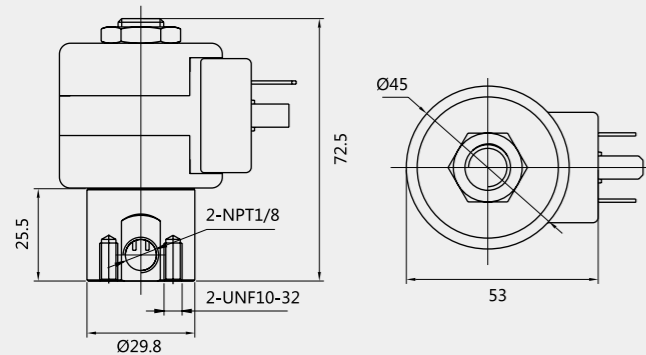

Features

Used in collection machine of freon

Technic data

Model	RV02352M-06B
Media	Freon
Working type	2/2 Bistable
Pattern	Normally close
Orifice	2.4mm
Connection ports	NPT 1/8
Working pressure	0~35bar
Rated voltage	DC6V~24V Pulse
Power	10.7W Pulse
Protection class	IP65
Insulation class	H class
Valve body material	Brass
Seal material	HNBR

SB125 Freon Solenoid Valve



Features

Commonly used for control of freon in industrial refrigeration
Screw type and welding type optional
Good water-proof, heat-proof characteristic
Various connection and voltages made to order of clients

Technic data

Model	Port Size	Orifice	Working pressure	Max. Working pressure	Rated voltage	Power
SB125-1020/2	1/4" Thread Port	2.5mm	21bar	30bar	DC24V AC24V~380V ±10%	8W
SB125-1020/3	3/8" Thread Port	3.0mm				
SB125-1028/3	3/8" Thread Port	3.0mm				
SB125-1064/3	3/8" Thread Port	7.0mm				
SB125-1064/4	1/2" Thread Port	7.0mm				
SB125-1070/4	1/2" Thread Port	12.5mm				
SB125-1070/5	5/8" Thread Port	12.5mm				
SB125-1090/5	5/8" Thread Port	16.5mm				
SB125-1070/6	3/4" Thread Port	17.0mm				
SB125-1028/2	1/4" Thread Port	2.2mm				
SB125-1068/2	3/8" Thread Port	7.0mm				
SB125-1068/4	1/2" Thread Port	7.0mm				
SB125-1078/4	1/2" Thread Port	12.5mm				
SB125-1078/5	5/8" Thread Port	12.5mm				
SB125-1078/6	3/4" Thread Port	17.0mm				
SB125-1078/7	7/8" Thread Port	16.5mm				
SB125-1078/9	1-1/8" Thread Port	25.5mm				
SB125-1079/7	7/4" Thread Port	12.5mm				
SB125-1099/9	1-1/8" Thread Port	16.5mm				
SB125-1079/11	1-3/8" Thread Port	25.5mm				
SB125-1079/13	1-5/8" Thread Port	27.0mm				

SB197 Stainless Steel Lever Valve

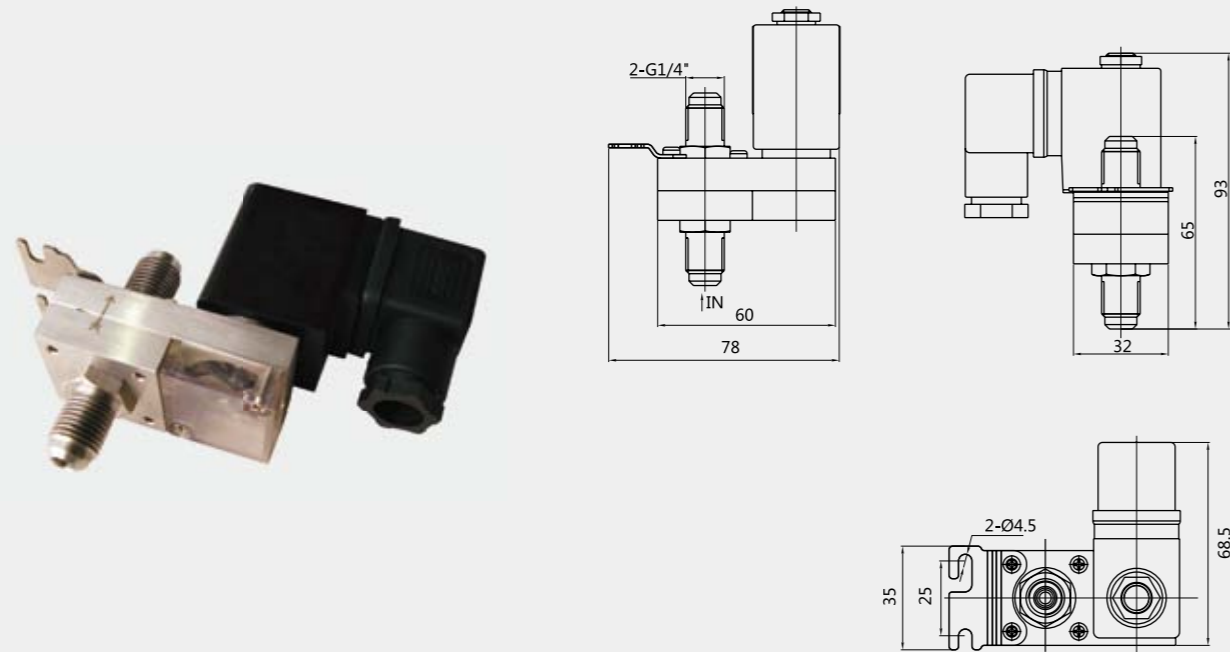

Features

Valve's On and Off is designed according to lever principle, High reliability, Wide range of working medium. The material of part which contact to working medium are VITON and SUS316, which and be widely used for Medical services, Food industry and so on.

Technic data

Model	SB197
Working pattern	2/2 Normal close
Working pressure	0~4bar
Orifice	4mm
Port Size	G1/2"
Body material	Stainless steel
Seal	VITON
Rated voltage	AC24V-220V ±10%
Power	AC22VA

RV004100-15G Dry type Aluminum Lever Valve

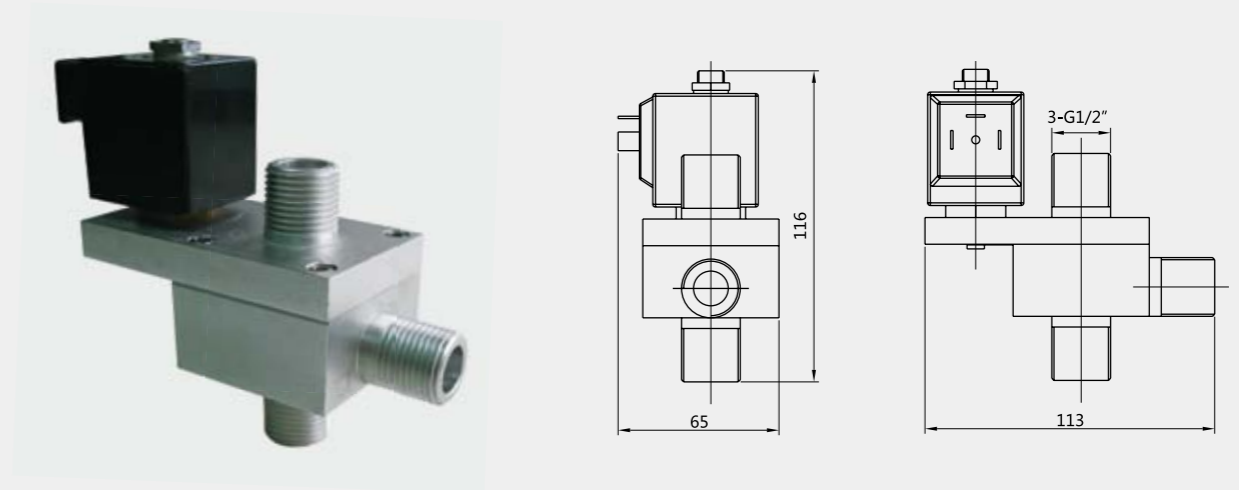

Features

Valve's On and Off is designed according to lever principle, High reliability, Wide range of working medium. The material of part which contact to working medium are NBR and Aluminum, which and be widely used for Medical services, Food industry and so on.

Technic data

Model	SB197
Working pattern	3/2
Working pressure	0~0.4bar
Orifice	10mm
Port Size	3- G1/2"
Body material	Aluminum
Seal	NBR
Rated voltage	AC24V-220V ±10%
Power	AC28VA



Warning

1. Our products are for industry use, pls. ask experienced person to use it.
2. Pls. use it according to the datas.
3. About safety management, pls. refer to relative industry standards and regulations.
4. Before you ensure the safety, pls. don't operate with the products:
 - a. Before you inspect and repair, pls. ensure it is safe.
 - b. Pls. pay attention even the product stops working, because some parts maybe electricity charged already, and maybe some parts are not fully cooled down.
 - c. Before you inspect and repair, pls. stop the supply of fluid, turn off the power, exhaust the fluid.
 - d. Before you restart the product, pls. ensure the system is safe and in case, there is failure of the product, there is precautions to avoid whole system out of control.

Notes for ordering

1. We will carry one year repair-free guarantee from the day goods be delivered.

2.The following problems not included above repair-free guarantee :

- a. Use the products in the condition which is not according to data.
- b. The problem cause is not product itself.
- c. Not use the product according to user manual.
- d. Modify the products by user himself.
- e. Unexpected technical problem unmentioned when ordering.
- f. Problem caused by unforeseen natural disasters.

3.Confirmation of applicability :

The user Have the obligation to confirm the product is suitable for the application before using it.



Solenoid Valve's Installation Remarks and Notes in use

1. Installation notice

- A. Check the model and parameter which print on the label, they must conform to actual technical requirements.
- B. Check solenoid coil, electromagnet and connetcor to make sure no damages.
- C. Clean the pipeline. The working medium of solenoid valve should be clean.
You should install filtering devices on the pipeline if the medium contains particle of impurities.
- D. Connect the valve port with pipeline according to the direction arrowhead indicates (same to the direction of medium flows), and make sure the connection seals good.
- E. The best installation method is perpendicular to pipeline and keep solenoid coil upward. The maximal inclination angle shoule be $\leq 30^\circ$, otherwise the normal operation cannot be promised.
- F. When the solenoid valve is installed outdoors, the protective cover is necessary to make sure the performance and longer service life.

2. Attentions

- A. Don't cover the solenoid coil when it is electrified that to avoid burnout because of overheating.
- B. Don't touch the solenoid coil during its working since the temperature is high because of heating itself.
- C. Don't hit and knock the solenoid coil, plug, electromagnet and connetor to avoid damage.
- D. The actual voltage cannot over regulated voltage.
- E. The working pressure, temperature and viscosity of media cannot over regulated range.
- F. Solenoid valve's inner part and filtering devices should keep clean.
- G. Normal type solenoid valve cannot be used in any explosive occasion.
- H. When the solenoid valve is not used, put it in a room that has temperature range 0°C to 40°C , relative humidity $\leq 80\%$ and has no corrosive gases.

3. Guarantee

- A. We will carry one year repair-free guarantee from the day goods be delivered.
- B. The following situation are not included in repair-free guarantee:
 - 1) The valve is not working normally or even damaged because the medium contains particle of impurities and the filtering devices is not installed.
 - 2) The service voltage is not conform to rated voltage that results in solenoid coil burn out or short circuit.
 - 3) The valve is not working normally or even damaged because of human destruction or incorrect use.
 - 4) The valve is not working normally or even damaged because the storage is in the open or inappropriate