

### Features

- \* Medium and compact size, 18mm width solenoid valve.
- \* Manual override design for easy test and operation.
- \* Anodized aluminum body and strict quality control provide a long durability.



### How to order

AM520	B	X	-	O1	N	-	S	2	D	LED
18mm valves series	Valve type	Acting style		Port size	Thread	Solenoid		Voltage	Coil type	LED
52 5/2 way 53 5/3 way	Blank Body ported B Base mounted	Blank Standard X Exhaust center Y Pressurized center		O1 1/8"	Blank PS N NPT	S Single solenoid D Double solenoid		1 110VAC 2 220VAC 9 24VDC	Blank Lead wire D DIN	Blank (W/O LED)

### How to order manifold

MF520	-	O1	N	-	O2
18mm valves series		Port size	Thread		Stations
For body ported valve		O1 1/8"	Blank PS N NPT		O2 2 stations O3 3 stations XX XX stations

### How to order manifold (B type)

SF520	-	O1	N	-	O2
18mm valves series		Port size	Thread		Stations
For base mounted valve		O1 1/8"	Blank PS N NPT		O2 2 stations O3 3 stations XX XX stations

### Specifications

Model	AM520-01-S(D)	AM520B-01-S(D)	AM530-01-D
Port size	1/8"		
Fluid	Compressed air		
Acting	Internal pilot		
Sectional area	11mm <sup>2</sup> / 25mm <sup>2</sup>		9mm <sup>2</sup>
Operating pressure range	1.5~8 kgf/cm <sup>2</sup>		2~7 kgf/cm <sup>2</sup>
Max. operating pressure	9.9 kgf/cm <sup>2</sup>		
Ambient temperature	-10°C ~ 50°C		
Duty cycle	100% ED		
Coil type	Lead wire (Standard), DIN (Option)		
Protection class	IP65 (DIN 40 050)		
Insulation class	F		
Voltage tolerance	±10%		
Standard voltage	220VAC, 110VAC, 24VDC (The other voltage is optional)		
Net weight	125g (195g)	580g (660g)	215g

### Flow chart

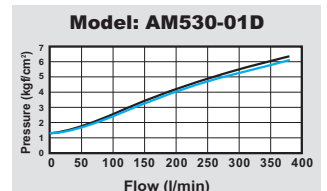
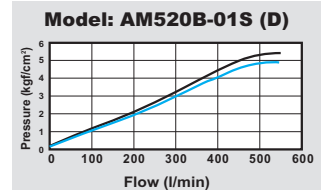
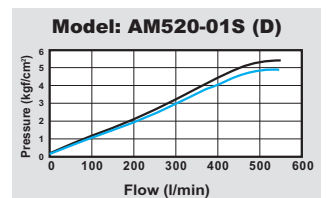



### Features

- \* Medium and compact size, 18mm width solenoid valve.
- \* Manual override design for easy test and operation.
- \* Anodized aluminum body and strict quality control provide a long durability.
- \* The mounting position is identical to the counter product from SMC.



### How to order

<b>SM520</b>	<b>X</b>	<b>01</b>	<b>N</b>	<b>S</b>	<b>2</b>	<b>D</b>	<b>LED</b>
<b>18mm valves series</b>	<b>Acting style</b>	<b>Port size</b>	<b>Thread</b>	<b>Solenoid</b>	<b>Voltage</b>	<b>Coil type</b>	<b>LED</b>
52 5/2 way 53 5/3 way	Blank Standard 5/3 way X Exhaust center Y Pressurized center	01 1/8"	Blank PS N NPT	S Single solenoid D Double solenoid	1 110VAC 2 220VAC 9 24VDC	Blank Lead wire D DIN	Blank (W/O LED)

### How to order manifold

<b>MF52S</b>	<b>01</b>	<b>N</b>	<b>03</b>
<b>Model number</b>	<b>Port size</b>	<b>Thread</b>	<b>Stations</b>
SM 18mm valves series	01 1/8"	Blank PS N NPT	02 2 stations 03 3 stations XX XX stations

### Specifications

Model	SM520-01-S	SM520-01-D	SM530-01-D
Port size	1/8"		
Fluid	Compressed air		
Acting	Internal pilot		
Sectional area	11mm <sup>2</sup>	9mm <sup>2</sup>	
Operating pressure range	1.5~8 kgf/cm <sup>2</sup>	2~7 kgf/cm <sup>2</sup>	
Max. operating pressure	9.9 kgf/cm <sup>2</sup>		
Ambient temperature	-10°C ~ 50°C		
Duty cycle	100% ED		
Coil type	Lead wire (Standard), DIN (Option)		
Protection class	IP65 (DIN 40 050)		
Insulation class	F		
Voltage tolerance	±10%		
Standard voltage	220VAC, 110VAC, 24VDC (The other voltage is optional)		
Net weight	125g	195g	215g

### Flow chart

Model: SM520-01S

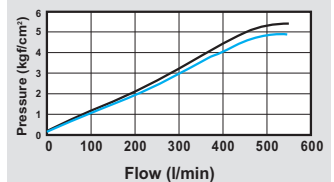

Model: SM520B-01S

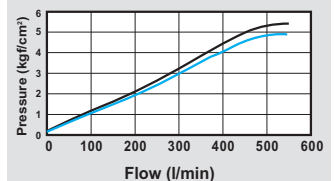

Model: SM530-01D

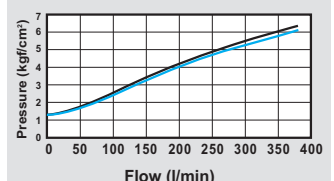

## Dimensions

### SM520-01-S

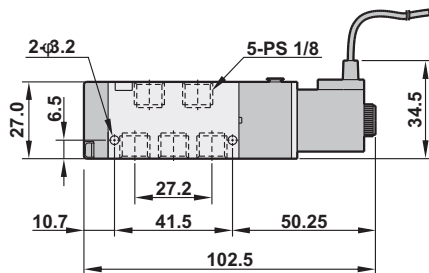
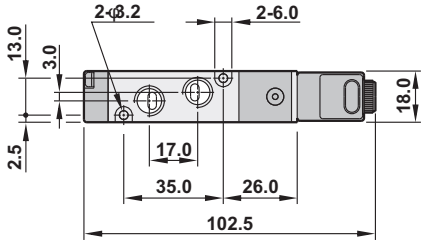
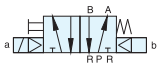

### SM520-01-D

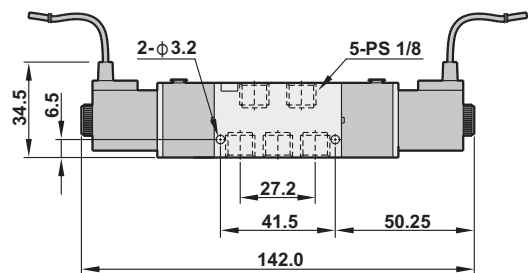
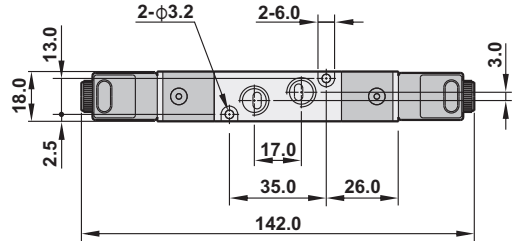
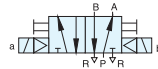

### SM530-01-D

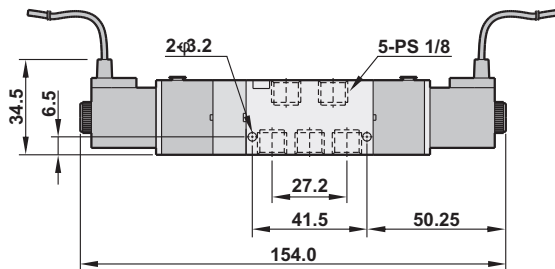
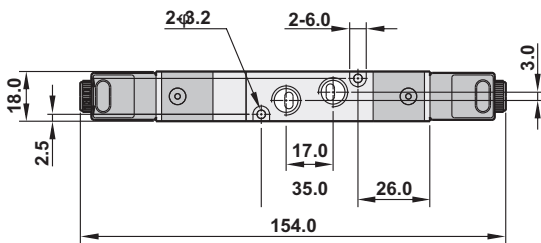
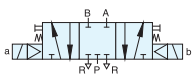

### MF52S-01-03

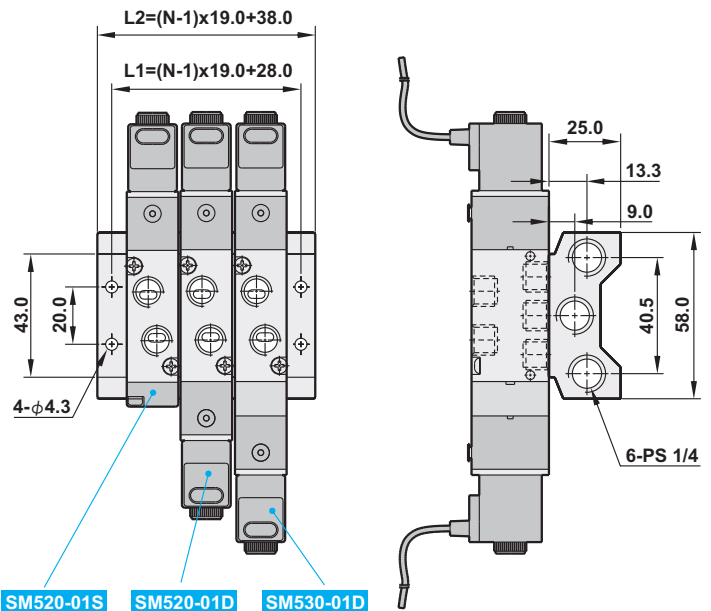

SM520-01S SM520-01D SM530-01D

Number of station (N)	2	3	4	5	6	7	8	9	10
L 1	47.0	66.0	85.0	104.0	123.0	142.0	161.0	180.0	199.0
L 2	57.0	76.0	95.0	114.0	133.0	152.0	171.0	190.0	209.0